

Quick Setup Guide

Guest Locator System



Components

- ANTFI Guestracker Server System (GSS)
- ECO Coaster Table Locator Pager
- ECO Coaster Charger Base
- RFID-Tags
- 5V 4A Power Adapter



Setup Guide

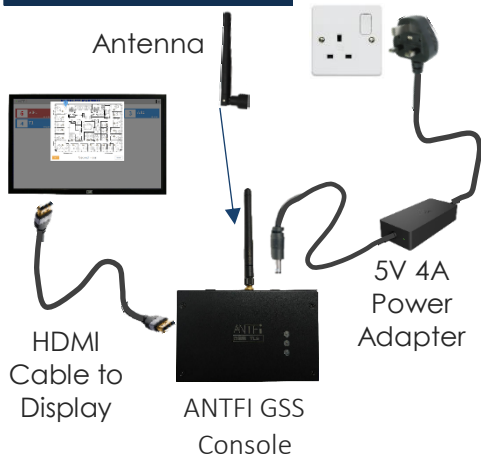

Step 1

Connect antenna to the GSS Console. Next connect GSS to your display using HDMI cable. Finally, plug the power adapter to the GSS and 3 pin plug into the electrical wall outlet.

Step 2

Identify a location on the table for the RFID tag. Paste the RFID tag on the table and then paste the label sticker over the RFID tag. Avoid stainless steel or metal table.

Step 3

Place pagers onto the charger base. You should see a **RED** light on each pager. The **RED** light indicates that the pager is "charging" and **GREEN** light indicates that it is fully charged.

Usage Guide

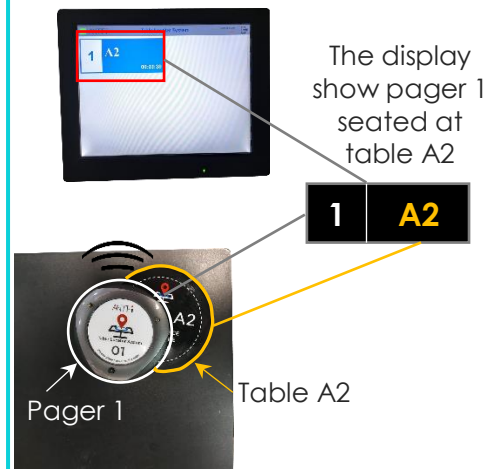

Step 1

Take a table locator pager from the charger base and hand it to the customer. Inform him/her to place the pager on top of the label.

Step 2

Once the pager is placed on top of the RFID tag, it will send the information to the GSS. The system will then display pager "1" patron is seated at table "A2".

Step 3

When pager "1" order is ready, deliver the order to table "A2". Take back the pager and return it back into the charging base. Upon returned, pager "1" will be removed from GSS.